

# Strainers with flanged connections

**Type 2 N**

**Type 2 NI**

**SAMSON**



Type 2 N/2 NI Strainers

## **Mounting and Operating Instructions**

**EB 1015 EN**

Edition June 2014

## Definition of signal words



### **DANGER!**

*Hazardous situations which, if not avoided, will result in death or serious injury*



### **WARNING!**

*Hazardous situations which, if not avoided, could result in death or serious injury*



### **NOTICE**

*Property damage message or malfunction*



### **Note:**

*Additional information*



### **Tip:**

*Recommended action*

1	General safety instructions.....	4
2	Design and principle of operation .....	5
3	Installation .....	6
4	Maintenance .....	6



### 1 General safety instructions

- The strainer is to be mounted, started up or serviced by fully trained and qualified personnel only; the accepted industry codes and practices are to be observed. Make sure employees or third persons are not exposed to any danger.
- According to these mounting and operating instructions, trained personnel refers to individuals who are able to judge the work they are assigned to and recognize possible dangers due to their specialized training, their knowledge and experience as well as their knowledge of the applicable standards.
- To ensure appropriate use, only use the device in applications where the operating pressure and temperatures do not exceed the specifications used for sizing the regulator at the ordering stage.
- The manufacturer does not assume any responsibility for damage caused by external forces or any other external factors.
- Any hazards that could be caused in the strainer by the process medium, operating pressure or by moving parts are to be prevented by taking appropriate precautions.
- Proper transport, storage, installation, operation and maintenance are assumed.

## 2 Design and principle of operation

Strainers protect downstream plants, aggregates as well as measuring and control equipment from becoming blocked up with dirt particles carried along by the process medium.

The strainers consist of a Y-shaped body with flanges, a filter element and a cover flange for the filter.

Type 2 N is equipped with a single wide-meshed filter element (standard strainer insert). Type 2 NI has a single filter element with an additional fine-meshed internal element (dual strainer insert).

The process medium flows through the body in the direction indicated by the arrow on the body. Any dirt particles in the pipeline are retained and collected in the filter element.

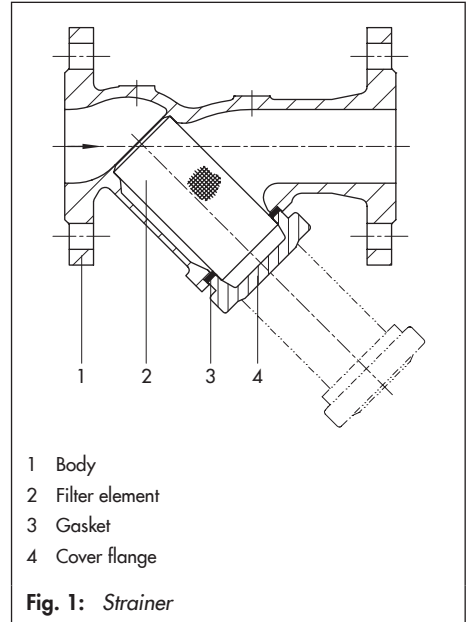

### 3 Installation

- The flow of direction must correspond with the direction indicated by the arrow on the valve body.

Leave enough space to remove the filter element.

- Cover with internal filter element pointing down (standard).

**For steam pipes:** Cover pointing to the side.

- Install strainers in vertical pipelines with the medium flowing upward with the cover flange pointing up as indicated by the arrow.

In this case, dirt particles are retained but not collected.

In cases where the filter element may be damaged by the backflow, an additional

support cage must be installed. If necessary, install swing check valves or similar equipment to prevent backflow.

### 4 Maintenance

To prevent wear, regularly check whether dirt, which could block the flow through the strainer, has collected. In this case, remove the strainer.

- Shut off and drain the section of the pipeline.
- Remove the cover flange (4). Remove the filter insert(s) and clean them.
- Replace damaged filter inserts (2). Always replace the gasket (3) after the filter insert has been removed.

Required parts, see Table 1.

**Table 1:** Order numbers for filters and gaskets · Tightening torques for cover flange screws

Nominal size	Type 2 N (standard insert)	Type 2 NI (dual insert)	Gasket	Number of cover flange screws	Tightening torque
	Order no.				
DN 15	0550-0222	0550-0238	8422-0011	2	~30 Nm
DN 20	0550-0223	0550-0239	8422-0019		
DN 25	0550-0224	0550-0240	8422-0023		
DN 32	0550-0225	0550-0241	8422-0029		
DN 40	0550-0226	0550-0242	8422-0039		
DN 50	0550-0227	0550-0243	8422-0048	4	~50 Nm
DN 65	0550-0228	0550-0244	8422-0056		
DN 80	0550-0229	0550-0245	8422-0065		
DN 100	0550-0230	0550-0246	8422-0076	6	~100 Nm
DN 125	0550-0231	0550-0247	8422-0084		
DN 150	0550-0232	0550-0248	8422-0092		
DN 200	0550-0233	0550-0249	8422-0102		
DN 250	0550-0234	0550-0250	8414-1510		
				10	

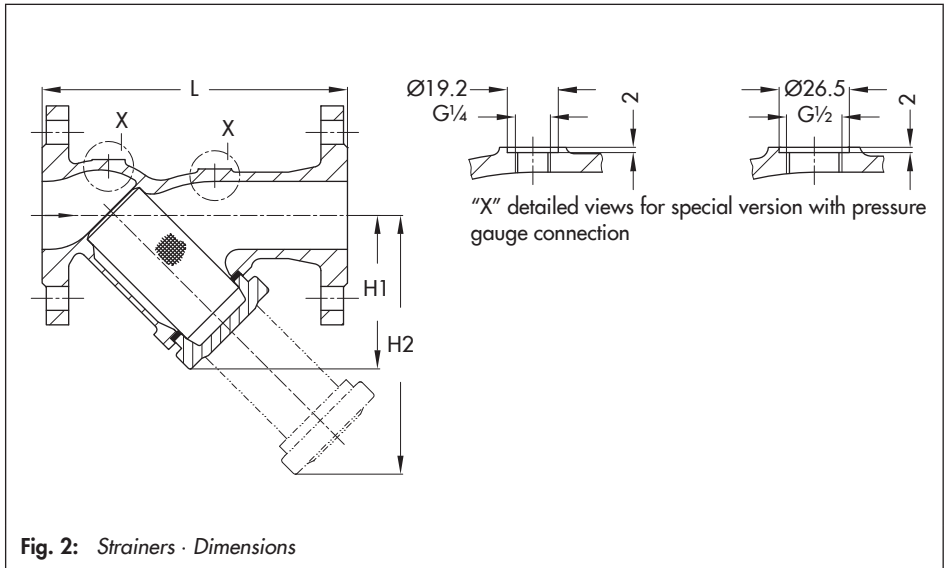

Table 2: Dimensions in mm and weights in kg

DN	15	20	25	32	40	50	65	80	100	125	150	200	250
Length L	130	150	160	180	200	230	290	310	350	400	480	600	730
Height H1	45	60	70	85	95	115	150	180	224	255	290	385	480
Height H2	75	90	110	135	160	195	225	295	343	420	485	640	790
<b>Weight, approx. kg</b>													
EN-JS1049, EN-JL1040 PN 16 to 40	1.9	2.8	3.3	5.4	6.5	9.1	12	17	24	36	52	91	152
1.0619	2.2	3.2	4.0	5.8	7.2	10	14	19	28	42	60	130	195

Additional details in ► T 1015 EN



SAMSON AG · MESS- UND REGELTECHNIK  
Weismüllerstraße 3 · 60314 Frankfurt am Main, Germany  
Phone: +49 69 4009-0 · Fax: +49 69 4009-1507  
[www.samson.de](http://www.samson.de) · [samson@samson.de](mailto:samson@samson.de)

**EB 1015 EN**

2014-09-11