

Self-operated Temperature Regulators



Type 4 Temperature Regulator

With balanced single-seated globe valve

Application

Temperature regulator for heating installations · Control thermostats for set points from -10 to $+250$ °C · Nominal sizes DN 15 to 150 · Nominal pressure PN 16 to 40 · Suitable for temperatures up to 350 °C

The valve **closes** when the temperature rises.



The regulators consist of a balanced globe valve with flanged connections and a control thermostat with temperature sensor, set point adjuster with excess temperature protection, capillary tube, and operating element.

Special features

- Low-maintenance proportional regulators requiring no auxiliary energy
- Wide set point range and convenient set point adjustment with a dial
- Single-seated valve with a plug balanced by a stainless steel bellows
- Valve body optionally available in cast iron, spheroidal graphite iron, cast steel or cast stainless steel
- Versions with double adapter and manual adjuster for temperature limiters or attachment of a second control thermostat. See ▶ T 2036 for details.

Versions

Type 4 Temperature Regulator · Type 2422 Valve with flanged connections · DN 50 to 150 · Balanced by a bellows PN 16 to 40 · Type 2231 to 2235 Control Thermostat
Further details on the application of control thermostats can be found in Information Sheet ▶ T 2010.

Type 2422/2231 (Fig. 1) · With Type 2422 Valve and Type 2231 Control Thermostat · Suitable for liquids · Set point adjustment at the sensor · Set points from -10 to $+150$ °C

Type 2422/2232 (Fig. 2) · With Type 2422 Valve and Type 2232 Control Thermostat · Suitable for liquids and steam
Separate set point adjustment · Set points from -10 to $+250$ °C

Type 2422/2233 (Fig. 3) · With Type 2422 Valve and Type 2233 Control Thermostat · Suitable for liquids, air, and other gases · Set point adjustment at the sensor · Set points from -10 to $+150$ °C

Type 2422/2234 · With Type 2422 Valve and Type 2234 Control Thermostat · Suitable for liquids, air, and other gases
Separate set point adjustment · Set points from -10 to $+250$ °C

Type 2422/2235 · With Type 2422 Valve and Type 2235 Control Thermostat · Installation in air-heated storerooms as well as drying, climatic, and heating cabinets · Separate set point adjustment and a sensor tube to be installed on site · Set points from -10 to $+250$ °C

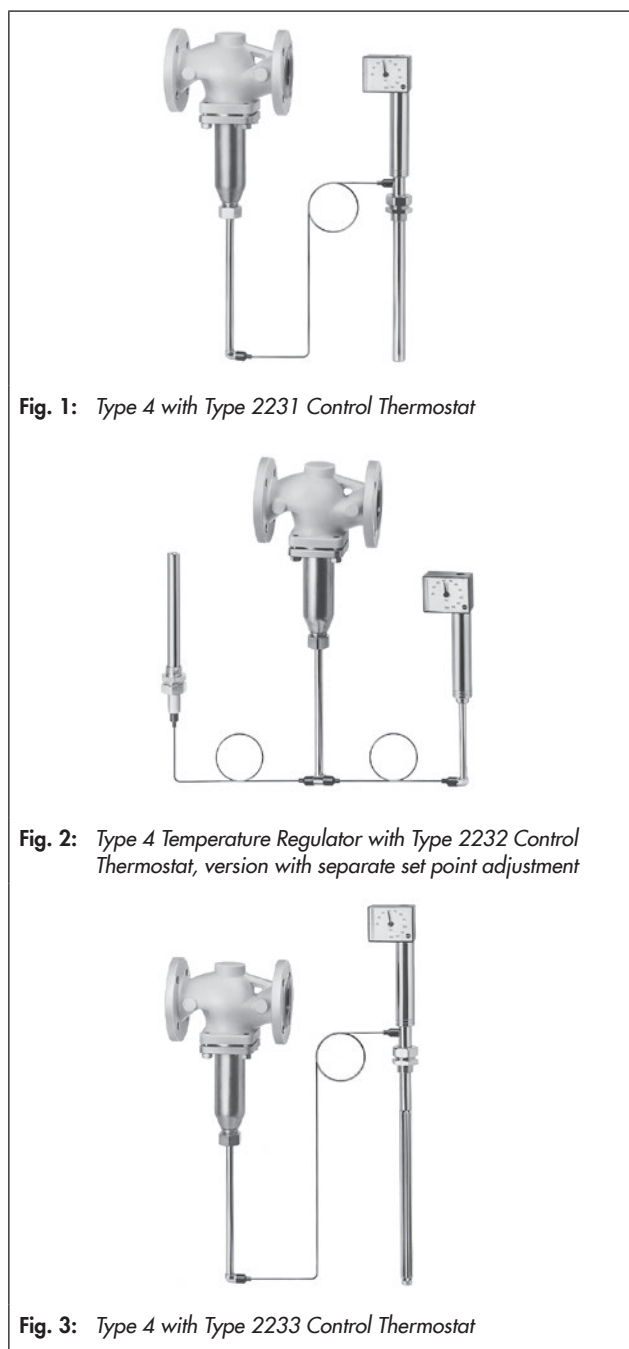

Fig. 1: Type 4 with Type 2231 Control Thermostat

Fig. 2: Type 4 Temperature Regulator with Type 2232 Control Thermostat, version with separate set point adjustment

Fig. 3: Type 4 with Type 2233 Control Thermostat

Special versions

- 5, 10 or 15 m capillary tube length
- Sensor of CrNiMo steel
- Capillary tube made of CrNiMo steel or plastic-coated copper
- Valve entirely of stainless steel
- Reduced K_{VS} coefficient
- Valve with flow divider for noise reduction with steam and non-flammable gases
- ANSI version (▶ T 2025)

Principle of operation (see Fig. 4)

The regulators operate according to the liquid expansion principle.

The temperature sensor (12), capillary tube (9), and operating element (7) are filled with an expansion liquid. The temperature-dependent change in volume of this liquid causes the operating bellows in the operating element (7) to move and, as a result, also moves the plug stem (5) with the attached plug (3).

The position of the plug determines the flow rate of the heat transfer medium across the area released between the seat (2) and plug (3).

The temperature set point is adjustable with a key (10) to a value which can be read off from the dial (11).

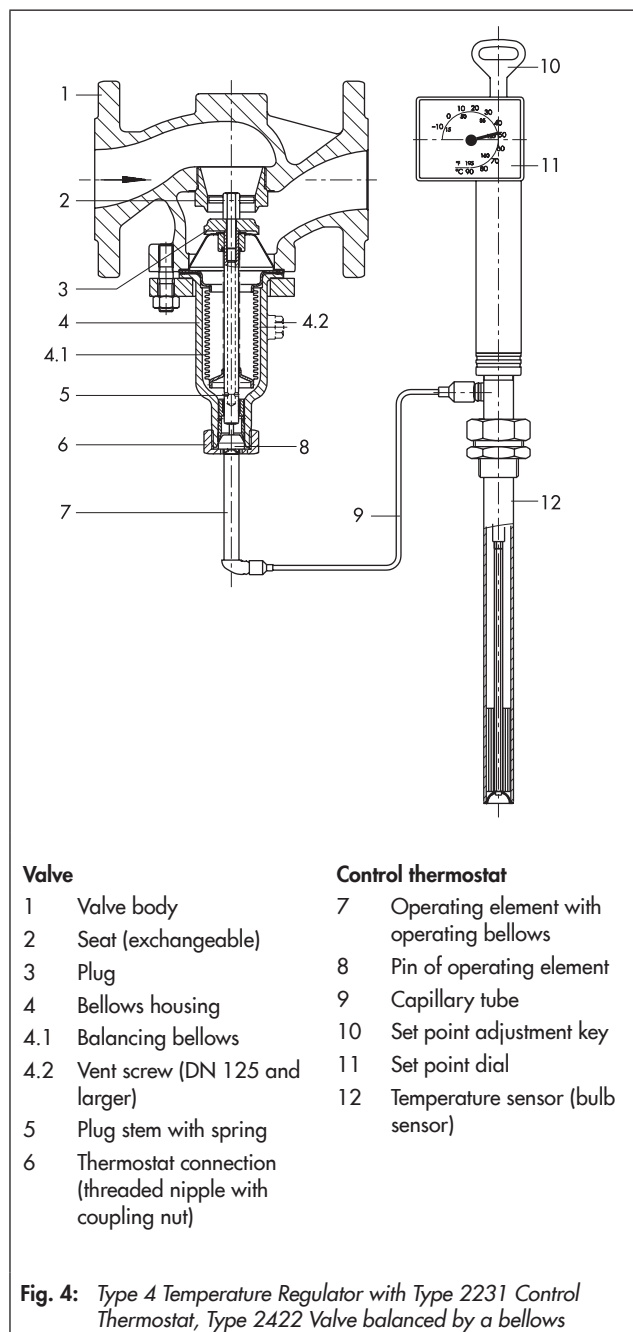

Valve

- 1 Valve body
- 2 Seat (exchangeable)
- 3 Plug
- 4 Bellows housing
- 4.1 Balancing bellows
- 4.2 Vent screw (DN 125 and larger)
- 5 Plug stem with spring
- 6 Thermostat connection (threaded nipple with coupling nut)

Control thermostat

- 7 Operating element with operating bellows
- 8 Pin of operating element
- 9 Capillary tube
- 10 Set point adjustment key
- 11 Set point dial
- 12 Temperature sensor (bulb sensor)

Fig. 4: Type 4 Temperature Regulator with Type 2231 Control Thermostat, Type 2422 Valve balanced by a bellows

Table 1: Technical data · Valves · All pressures in bar (gauge)

Type 2422 Valve, balanced by a bellows												
Nominal pressure	PN 16 to 40											
Nominal size	15	20	25	32	40	50	65	80	100	125	150	
K_{VS} coefficient in m^3/h	4	6.3	8	16	20	32	50	80	125	190	290	
Leakage class according to IEC 60534-4	Metal seal: ≤ 0.05 % of K_{VS} coefficient Soft seal: ≤ 0.01 % of K_{VS} coefficient)											
Max. perm. differential pressure Δp in bar	25						16		16		12	
Special version												
K_{VS} coefficient in m^3/h	2.5, 4, 6.3		6.3	8	16	20	32	80	-	-		
Max. perm. differential pressure Δp in bar	25								16		-	
Permissible valve temperature	Max. 350 °C · See pressure-temperature diagram in ▶ T 2010											
Compliance	CE · EAC											

Table 2: Technical data · Control thermostats

Type 2231 to 2235 Thermostat	Size 150
Set point ranges	-10 to +90 °C, 20 to 120 °C or 50 to 150 °C · For Types 2232, 2234, and 2235 also 100 to 200 °C, 150 to 250 °C
Perm. ambient temperature at the set point adjustment	-40 to +80 °C
Permissible temperature at sensor	100 K above the adjusted set point
Permissible pressure at sensor	Without/with thermowell: PN 40 · Thermowell with flange: PN 40
Type 2231/2232	
Type 2233/2234	Without thermowell: PN 40 · With flange on request
Capillary tube length	3 m (5, 10 or 15 m as special version)

Table 3: Materials · Material numbers according to DIN EN

Type 2422 Valve, balanced by a bellows				
Nominal pressure	PN 16	PN 16/25	PN 16, 25, and 40	
Body	Cast iron EN-GJL-250	Spheroidal graphite iron EN-GLS-400-18-LT	Cast steel 1.0619	Cast stainless steel 1.4408
Seat and plug ¹⁾	Up to DN 100	Cast stainless steel 1.4006, 1.4104, 1.4112		1.4404
	DN 125 to 150	1.4404 · Plug with PTFE seal		1.4404
Plug stem/spring	1.4301/1.4310			
Balancing bellows	1.4571			
Bellows housing	1.0425			1.4301
Gasket	Graphite on metal core			
Extension piece/separating piece	Brass (for version free of non-ferrous metal: 1.4301)			1.4301
Types 2231, 2232, 2233, 2234, and 2235 Thermostat				
	Standard version		Special version	
Operating element	Nickel-plated brass			
Sensor	Type 2231/2232	Bronze		Stainless steel 1.4571
	Type 2233/2234	Copper		
	Type 2235	Copper		
Capillary tube	Nickel-plated copper		Plastic-coated copper or stainless steel 1.4571	
Thermowell				
With G 1 threaded connection				
	Thermowell	Bronze, steel, copper ²⁾		Stainless steel 1.4571
	Threaded nipple	Brass		
With flanged connection (on request)				
	Thermowell	Steel		Stainless steel 1.4571
	Flange	Steel		

¹⁾ Optionally soft-seated plug with PTFE ring for temperatures up to 220 °C or with EPDM ring for temperatures up to 150 °C.

²⁾ PN 16 only

Typetested safety devices

The register number is available on request.

The following versions are available:

Temperature regulators (TR) with a Type 2231, 2232, 2233, 2234 or Type 2235 Thermostat and a Type 2422 Valve in DN 15 to 150, for which the maximum operating pressure must not exceed the maximum permissible differential pressure Δp specified in the technical data.

Sensors without thermowell: applicable up to 40 bar

Sensors with thermowell: only use SAMSON G 1 version made of bronze, steel or stainless steel up to 40 bar, copper up to 16 bar.

Thermowell for flammable gases typetested by DVGW, G 1 threaded connection, PN 100.

Further details on the selection application of typetested equipment can be found in Information Sheet ► T 2040.

Additionally, the following are available:

Safety temperature monitors (STM) and **safety temperature limiters (STL)**. Details in Data Sheets ► T 2043 and ► T 2046.

Accessories (see Fig. 6)

Thermowells with threaded or flanged connections for Types 2231 and 2232 Bulb Sensors · G 1 threaded connection, made of bronze, steel or CrNiMo steel (PN 40) or made of copper (PN 16) · Flanged connection, DN 32, PN 40, with thermowell made of CrNiMo steel or steel · Thermowell made of PTFE, PN 6 (flange PN 40).

Thermowell for flammable gases **typetested by DVGW**, G 1 threaded connection, PN 100.

Mounting parts for Types 2233 and 2235 · Clamps for wall mounting · Perforated cover for thermostat

To protect the operating element from inadmissible operating conditions, an **extension piece** or **separating piece** must be installed between the valve and the operating element.

An **extension piece** is needed for temperatures over 220 °C. The standard version does not have sealing. The special version of the extension piece for DN 15 to 100 is made of stainless steel and has a bellows seal. It additionally acts as a separating piece.

In combinations with valves made of cast iron or spheroidal graphite iron together with Type 2212 Safety Temperature Limiter or Type 2213 Safety Temperature Monitor, an extension piece is required for temperatures over 150 °C.

Separating piece made of brass (for water and steam) or CrNi steel (for water and oil)

A separating piece must be used when a seal between thermostat and valve is required. Separating pieces made of CrNi steel must be used when all wetted parts are to be free of non-ferrous metals. In addition, it prevents the medium from leaking while the thermostat is being replaced.

Do2 double adapter for second thermostat · **DoS** with electric signal transmitter

Manual adjuster Ma with travel indicator · **MaS** with electric signal transmitter

Dynamic behavior of the thermostats

The dynamics of the regulator are mainly determined by the response of the sensor with its characteristic time constant.

Table 4 lists the response times of SAMSON sensors operating according to different principles measured in water.

Table 4: Dynamic behavior of SAMSON thermostats

Functional principle	Control thermostat Type	Time constant [s]	
		Without Thermowell	With Thermowell
Liquid expansion	2231	70 s	120 s
	2232	65 s	110 s
	2233	25 s	– ¹⁾
	2234	15 s	– ¹⁾
	2235	10 s	– ¹⁾
Adsorption	2213	70 s	120 s
	2212	– ¹⁾	40 s

¹⁾ Not permissible

Installation

Valve

Install the valve in horizontal pipelines. The thermostat connection (6) must face downwards. The direction of flow must match the direction indicated by the arrow on the body.

Capillary tube

The capillary tube must be run in such a way that the ambient temperature range cannot be exceeded, any deviations in temperature cannot occur and that the tube cannot be damaged. The smallest permissible bending radius is 50 mm.

Temperature sensor

The temperature sensor may be installed in any position. Its entire length must be immersed in the medium. It must be installed in a location where overheating or considerable idling times cannot occur.

Only the combination of the same kind of materials is permitted, e.g. a stainless steel heat exchanger with thermowells made of stainless steel 1.4571.

Flow rate diagram for water

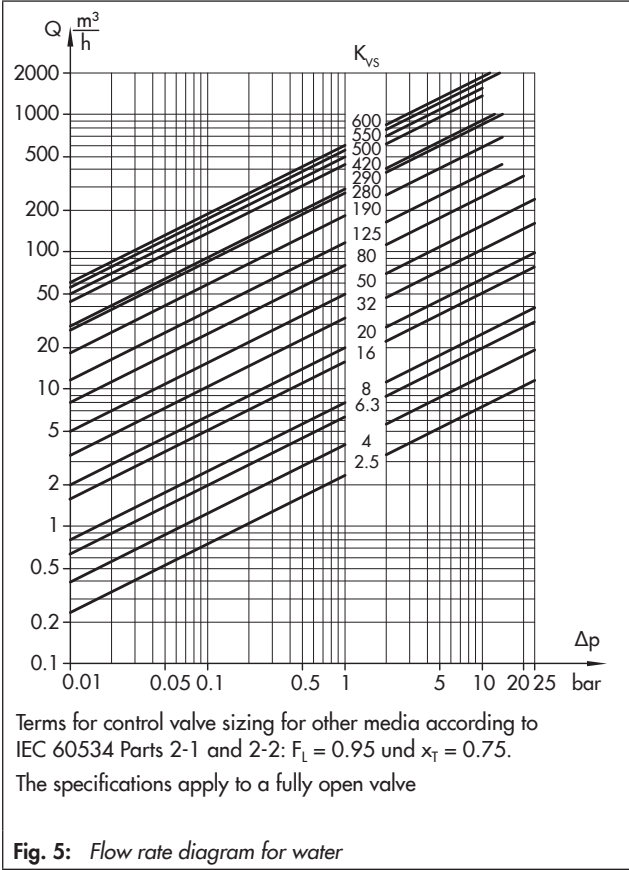

Dimensions of Type 2422 Valve

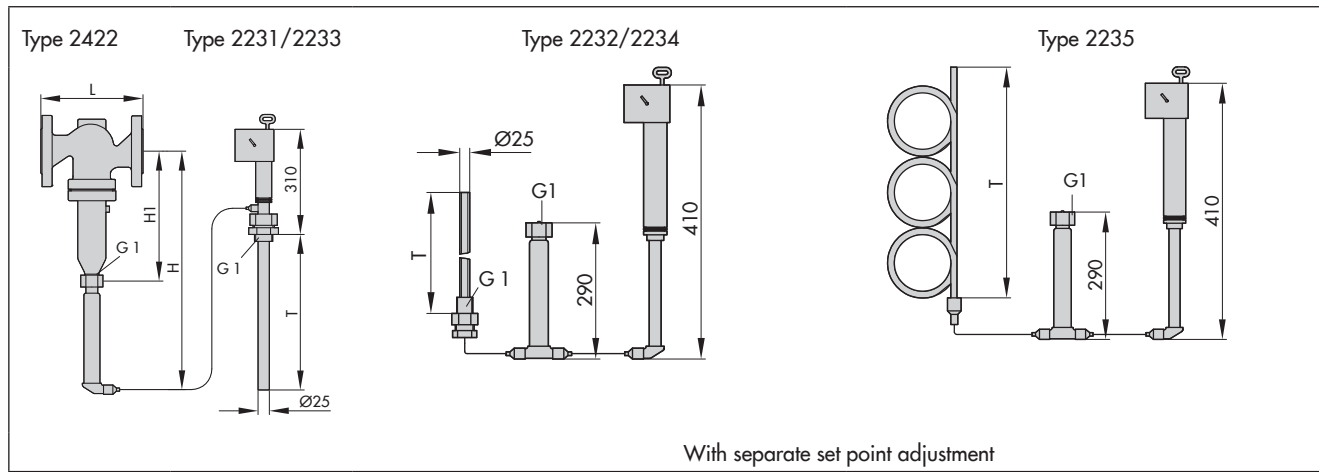

Table 5: Dimensions in mm and weights · Type 2422 Valve

Type 2422 Valve												
Nominal size	DN	15	20	25	32	40	50	65	80	100	125	150
Length L		130	150	160	180	200	230	290	310	350	400	480
H1	Up to 220 °C (without extension piece)	225						300		355	460	590
	Up to 350 °C (with extension piece)	365						440		495	600	730
H	Up to 220 °C (without extension piece)	515						590		645	750	880
	Up to 350 °C (with extension piece)	655						730		785	890	1020
Weight ¹⁾ , approx.	kg	5	5.5	6.5	13	13.5	16	27	32	40	70	113

¹⁾ Based on PN 16: +15 % for PN 25 and 40

Table 6: Types 2231 to 2235 Control Thermostat

Control thermostat	Type 2231	Type 2232	Type 2233	Type 2234	Type 2235
Immersion depth T	290 ¹⁾	235 ¹⁾	430	460	3460
Weight, approx.	kg 3.2	4	3.4	3.7	3.6

¹⁾ Larger immersion depths on request

Accessories

Thermowells for Type 2231/2232

Thermostat	Type 2231	Type 2232
T2	325 mm	250 mm

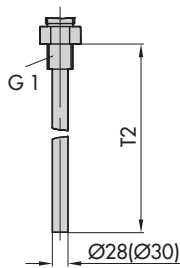

With threaded connection

G 1 for PN 40, PN 100
(dimensions for PN 100 in parentheses), thermowell made of copper: PN 16

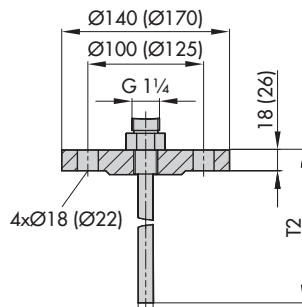

With flanges

DN 32 for PN 40
DN 40 for PN 100 (dimensions in parentheses)

Clamps and perforated cover for wall mounting

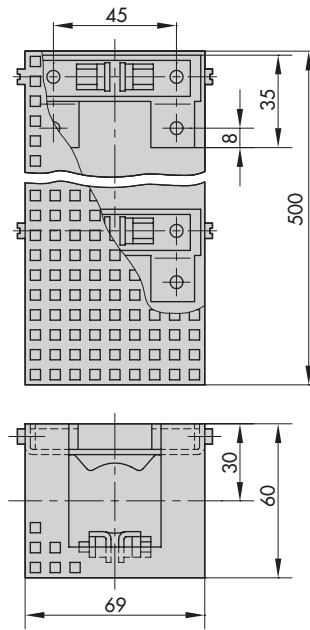

Extension piece/separating piece

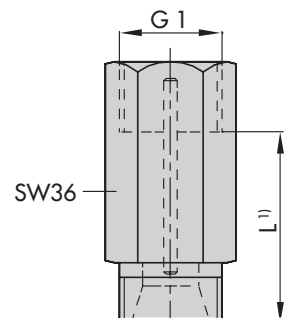

Extension piece

Standard version
L = approx. 140 mm, approx. 0.5 kg
With bellows seal (special version),
L = approx. 180 mm, approx. 0.6 kg

Separating piece with seals,
L = approx. 55 mm, approx. 0.2 kg

1) Add the dimension L to H and H1 when these accessories are used.

Thermowells for flammable gases (G 1/PN 100)

Thermostat	Type 2231	Type 2232
Length L1	315 mm	255 mm
Length L2	340 mm	280 mm

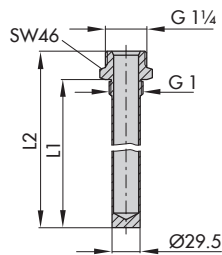

Flange for Type 2233 and Type 2234

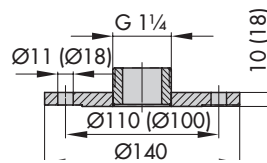

Flanged connection PN 6; 140 outside Ø
Flange PN 40/DN 32 (dimensions in parentheses)

All dimensions in mm

Fig. 6: Accessories

Ordering text

Type 4 Temperature Regulator/....,

DN ..., PN ...

Body material ...

With Type ... Thermostat, set point range ... °C

Capillary tube ... m

Optionally, special version ...

Optionally, accessories ...

Specifications subject to change without notice



SAMSON AG · MESS- UND REGELTECHNIK
Weismüllerstraße 3 · 60314 Frankfurt am Main, Germany
Phone: +49 69 4009-0 · Fax: +49 69 4009-1507
samson@samson.de · www.samson.de

T 2121 EN

2017-08-11 · English